

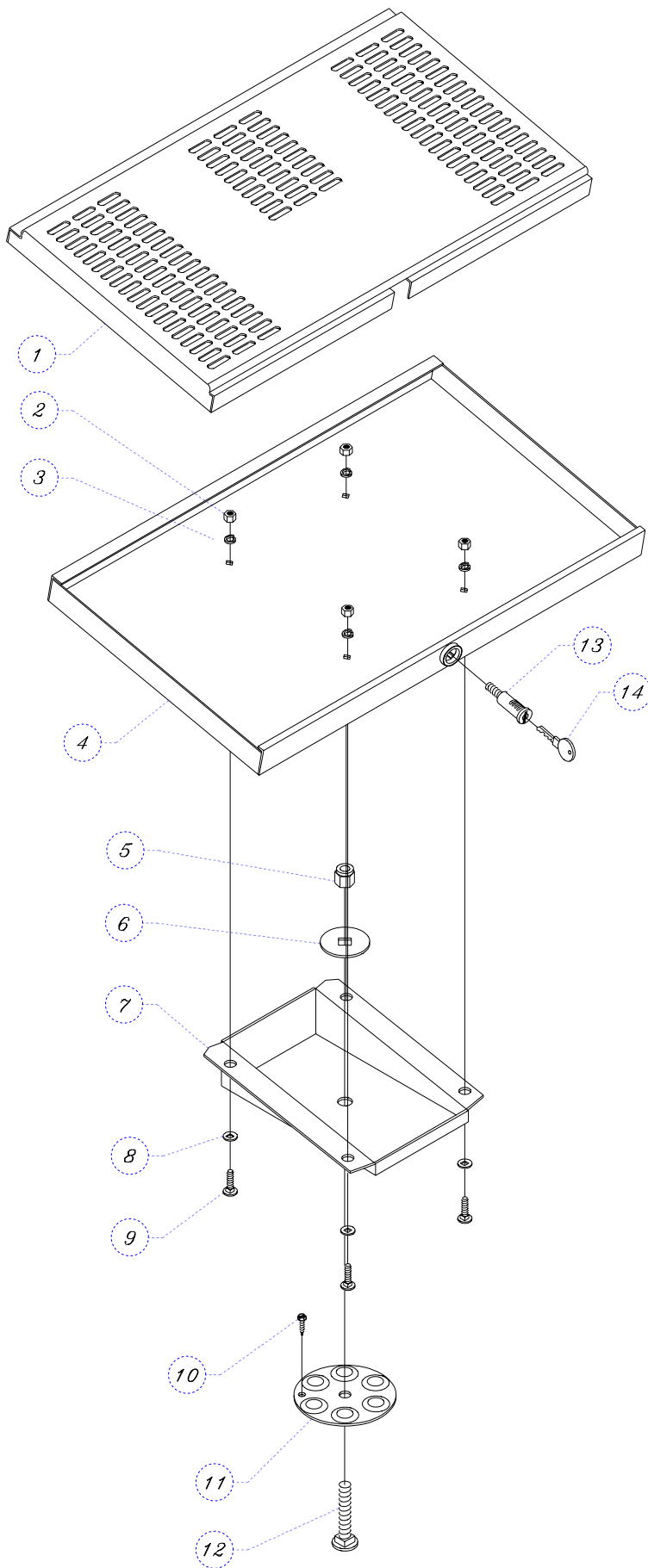

FMAST12

with

F61 Series Locking Mounts



1. Check beneath mounting surface for any obstacles which might hinder or prevent installation. Verify sufficient clearance from walls and other furniture to permit monitor rotation.
2. Drill a 1/2" diameter hole through the mounting surface. Place swivel plate (#11) over the hole. Secure swivel plate in place with the #10 x 5/8" hex washer head screw (#10).
3. Place tilt plate on swivel plate, and insert the 1/2-13 x 2-1/2" carriage bolt (#12) through drilled hole from underside of the mounting surface and through swivel and tilt plates. Place 2-1/8" washer (#6) over carriage bolt, and place 1/2-13 nylon lock nut (#5) on the carriage bolt. Tighten lock nut.
4. Place lower plate (#4) on tilt plate (#7), aligning the holes in lower plate with holes at corners of tilt plate.
5. Secure lower plate to tilt plate with four 1/4-20 x 1/2" carriage bolts (#9) and 1/4" square hole washers (#8) through bottom of the tilt plate and four lock washers (#3) and 1/4-20 nuts (#2) on lower plate.
6. Invert monitor. Place inverted upper plate (#1) on bottom of monitor with lock slot facing front of monitor. Attach upper plate to monitor with fasteners appropriate to the underside of the monitor.
7. Turn monitor right side up. Place upper plate on lower plate, guiding rear of upper plate beneath lip at back of lower plate. Slip upper plate into lower plate and pull forward until front of upper plate meets front of lower plate.
8. Place key (#14) in lock (#13) and insert lock into lock retainer in plate assembly. Turn key clockwise until lock has been completely screwed in, then turn key back (counter-clockwise) until key is vertical. Remove key.