

LCDU375S & LCDU550S

Wall Mount with Security Screws for 9" to 21" Flat Panel Screens with 100mm x 100mm or 75mm x 75mm Mounting Patterns

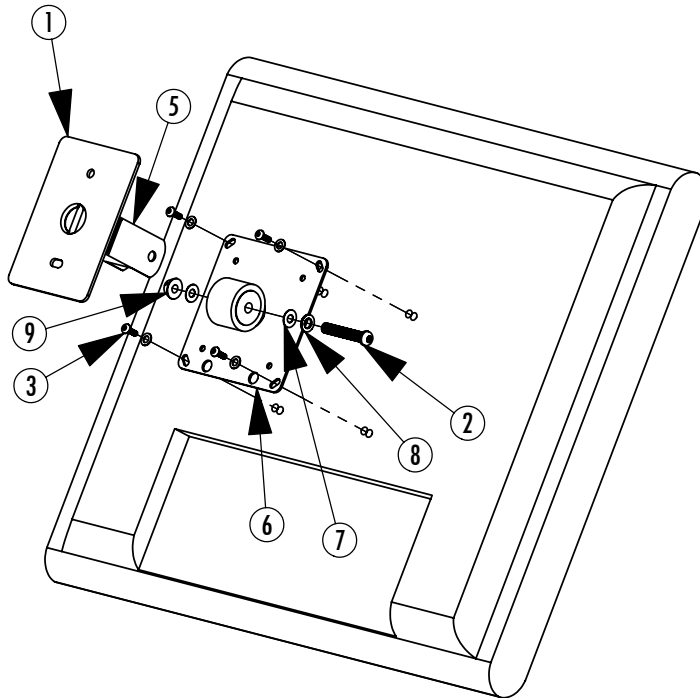

1. Remove flanged socket head cap screws (#2), washers (#7 & 8), and trigroove nuts (#9) from LCD wall mount arm.

2. Attach adaptor plate (#6) to monitor with screws appropriate for your monitor. M4 x 12mm x .7P security screws are provided.

Note: Some monitors may require adding spacers between monitor and LCD adaptor plate, additional washers (#11) have been provided.

3. Predetermine the best possible viewing location for monitor and attach LCD wall plate to studs in wall with appropriate hardware. One-Way Lag Screws (#4) have been provided for attachment to wood stud walls.

4. Attach LCD wall arm and monitor to LCD wall plate with hardware that was removed in step #1. Use thread locking agent (#12) on these threads to prevent their easy removal. Make sure the tilt and pivot are adjusted before the thread locking agent sets.

5. Check assembly for stability. Ensure all fittings and fasteners are properly tightened and safe.

6. Use plastic ties (#10) to tie up any loose cords.

**Note: Security Tool Kit (LCDSTK) Sold Separately
Security tools are required for this installation.**

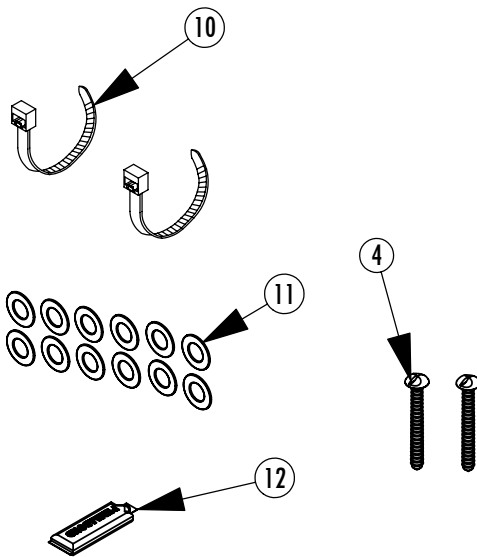

ITEM NO.	DESCRIPTION	Qty.
1	LCDU Wall Plate	1
2	5/16-18 x 2" Pin Head Security Screws	2
3	M4 x 12mm Pin Head Security Screws	4
4	#14 x 2-1/2" One-way Wood Lag Screws	2
5	3.75" or 5.5" Wall Arm	1
6	75/100mm Adaptor Plate	1
7	5/16" Belleville Washers	4
8	5/16" Flat Washers	2
9	5/16 -18 Trigr groove Nuts	2
10	Plastic Ties	2
11	5mm Flat Washers	12
12	1/2ml Tube HM128 Thread Locking Agent	1