

SLELCDT

STEALTH LOCKING FURNITURE MOUNT

Fits up to 32" flat panel monitors with 200mm x 200mm, 200mm x 100mm, 100mm x 100mm and 75mm x 75mm VESA® mounting patterns.

SECURITY LOCKING MECHANISM

Traps the monitor attaching hardware and prevents access to the hardware attaching to the furniture. Prevents theft of the monitor.

CONVERT OLD CRT TUBE TVS TO LCD FLAT SCREENS

The mounting base used for the SLELCDT is the same base used in other SLE type products from Lucasey Manufacturing for CRT Tube TVs. The interchangeable base can be used to convert from existing SLE CRT TV mounts to Flat Screens.

SECURITY RELEASE TOOL

The patented security mechanism used for the SLELCDT ensures that the flat screen can not be easily removed from its mounted location without the appropriate security removal tool.

PROTECT EXPENSIVE COUNTERTOPS

When mounting on furniture that has marble, granite or Corian® surfaces, where the countertop can not be screwed into, Lucasey has an optional adhesive accessory that can be used. The APSLEADS furniture mounting accessory, sold separately, uses an adhesive pad to connect with the countertop, screws into the back of the furniture and attaches to the SLELCDT Base. This maintains the security for the monitor while preventing damage to expensive countertops.

FAST INSTALLATION

Once the proper mounting location is determined, the SLE Base can be installed very quickly onto the furniture. The SLELCDT can be assembled and attached to the monitor in a few minutes. For commercial installations, many rooms can be finished in a short time.

EASY CARE AND MAINTENANCE

The decorative plastic cover allows for easy cleaning under and around the monitor. Clean with a soft dust cloth and do not use any cleaners that may damage the plastic or metal surfaces.

Important! Please read all warnings and cautions before installing the mount.

Caution: Improper installation of this mount may void the warranty on your monitor.

Caution: Installation should be performed by qualified installers only, using construction methods prescribed by authorized architects or engineers that comply to all applicable codes and standards.

The maximum weight of monitor to be installed on the SLELCDT is 50 Lbs. (22.7 Kg.)

Inspect all parts to make sure there is no shipping damage. Do not install if any parts are missing or damaged.

Please call 1-800-LUCASEY or 1-510-534-1435 if you have any questions about this installation.

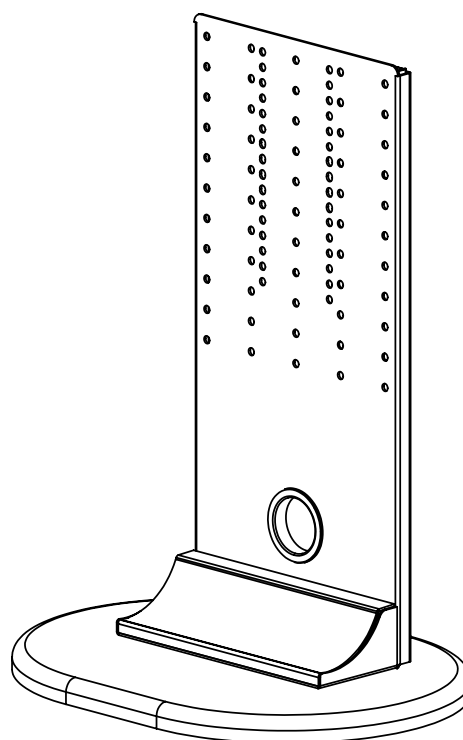
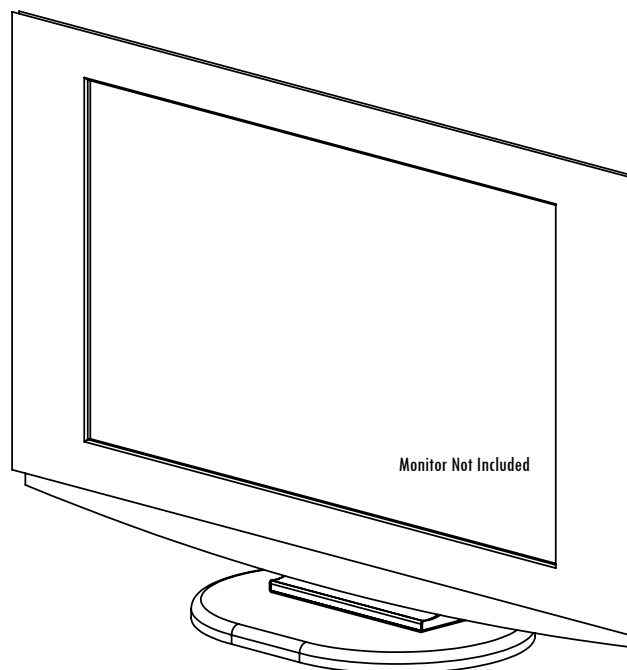

Front View

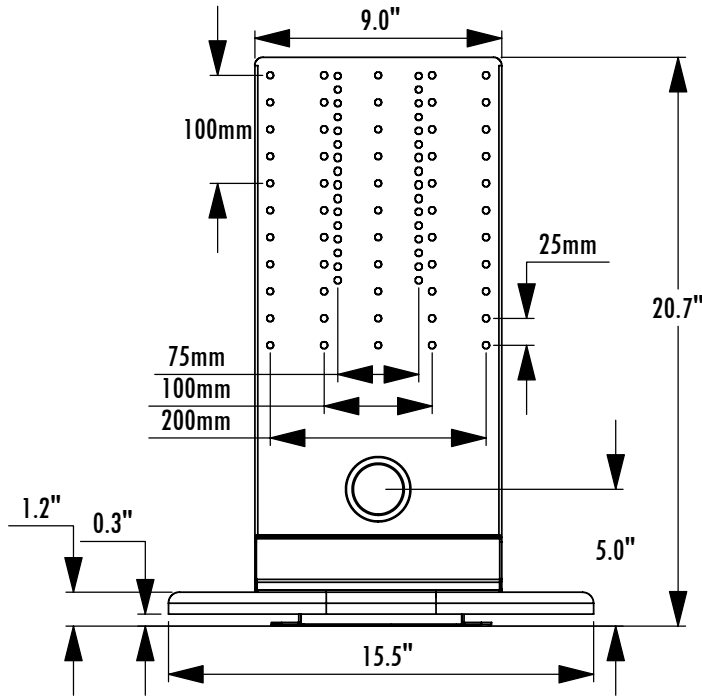

Component List

Unpack all of the components from the box and check against the component list below.

- 1 ... Base
- 1 ... SLELCDT Top
- 1 ... Rivet Plate
- 1 ... Plastic Cover
- 1 ... Back Cover
- 2 ... Spacers
- 2 ... Stabilizers with Screws & Washers
- 1 ... Swivel Stop with Nylock Nut & Washer
- 1 ... Plastic Edge Protector
- 6 ... Countersunk Screws
- 4 ... Tapping Screws
- 4 ... 4mm x 40mm Setscrews
- 4 ... 4mm x 12mm Phillips Screws
- 8 ... 4mm Hex Nuts
- 4 ... 5mm x 40mm Setscrews
- 4 ... 5mm x 12mm Phillips Screws
- 8 ... 5mm Hex Nuts
- 4 ... 6mm x 40mm Setscrews
- 4 ... 6mm x 12mm Phillips Screws
- 8 ... 6mm Hex Nuts
- 12 ... 5mm Washers
- 12 ... 1/4" Washers

Side View

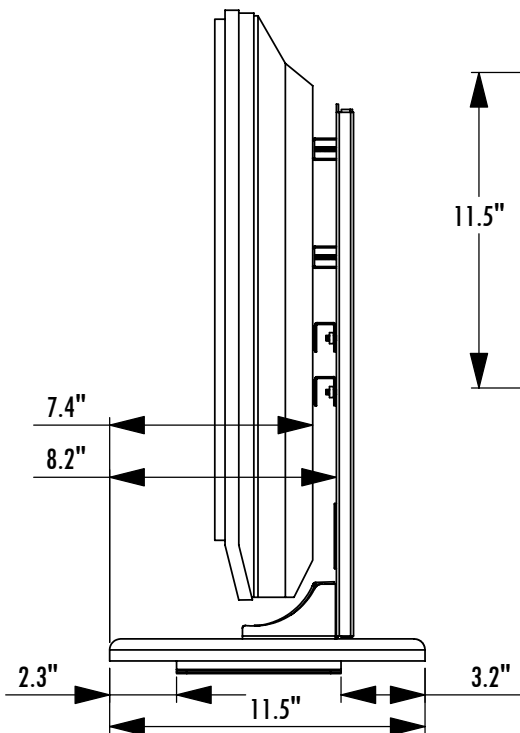

Top View

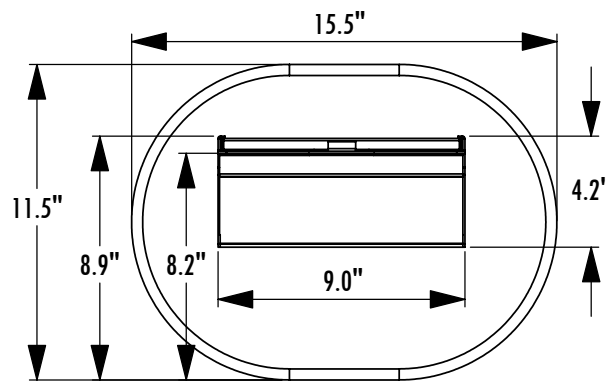

Bottom View

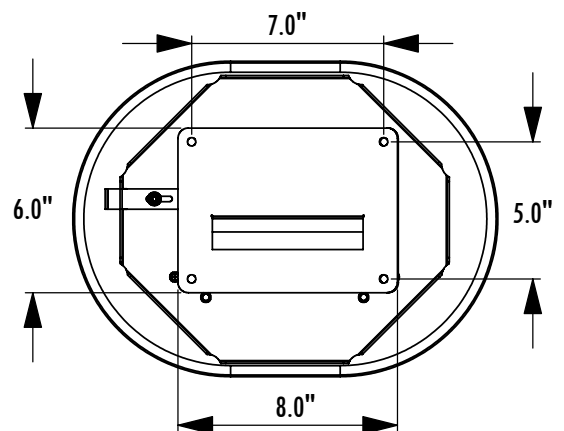

Furniture Placement Top View

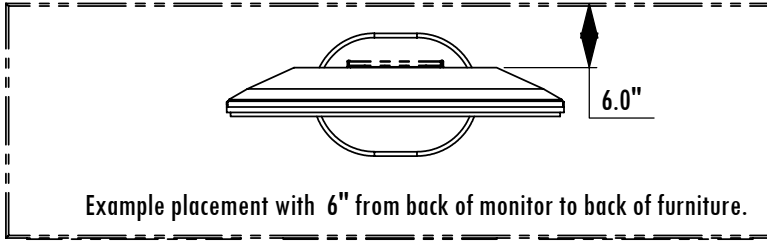

Base Furniture Placement Top View

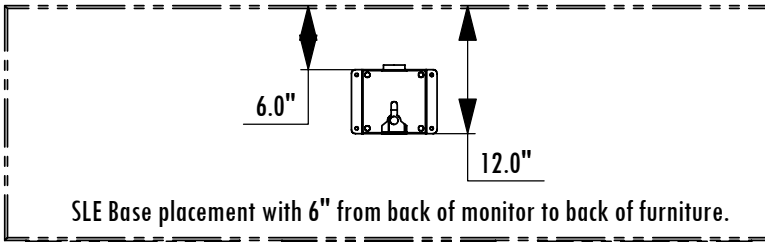

Furniture Placement Top View with Swivel

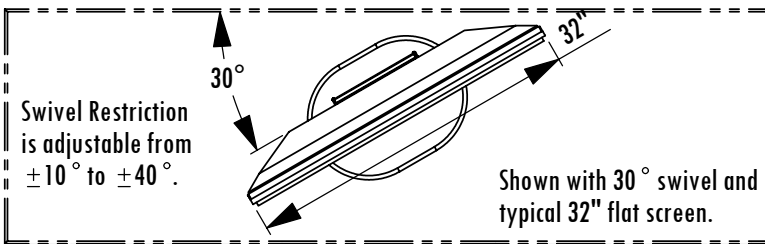

Swivel Restrictor Stop

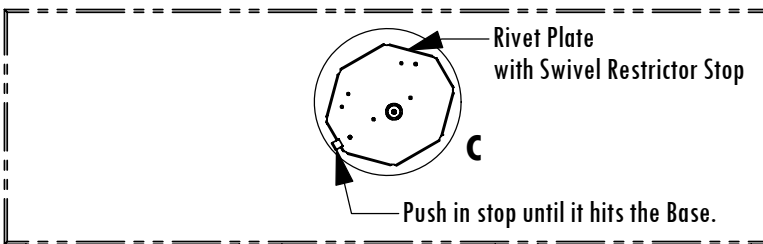

Top View

Detail C

Bottom View

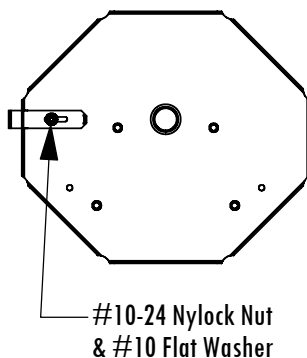
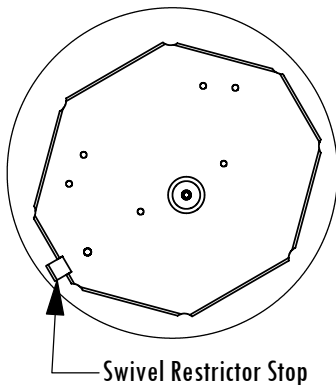

Base Placement

Determine the best placement on the furniture and viewing angle for the monitor being mounted. Take into account the distance from the wall when the monitor is swiveled.

Place the Base in the exact location to mount the monitor in the proper viewing location and mark the base location for installation.

Swivel Restrictor Stop

If the installation requires that the swivel be restricted, determine the extent of swivel desired with the Rivet Plate attached to the Base.

With the #10-24 Nylock Nut only hand tight, swivel the Rivet Plate to the desired degree of swivel and push the Swivel Restrictor Stop in until it hits the Base.

Without moving the Swivel Restrictor Stop, swivel the Rivet Plate back to neutral and release the Base from the Rivet Plate. See the SLELCDT Base Release Instructions for details on releasing the Base from the Rivet Plate.

Tighten the #10-24 Nylock Nut to fix the Swivel Restrictor Stop in place.

Protected under one or more of these U.S. Patent numbers: 3,291,432; 3,159,942; 3,724,798; DES:270,689; 4,613,109; 4,878,645; 4,852,842; DES:309,5624; 973,023; 5,169,114; 5,255,884; 5,310,159; 5,522,576; 5,621,614; Re:35,677; DES:398,834; 5,826,384; 5,941,492; 5,964,068; 6,060,661; 6,102,398; 6,138,704; 6,454,116; 6,761,276; 6,816,425; 6,816,425; 6,816,425

Base Installation Using Wood Tapping Screws

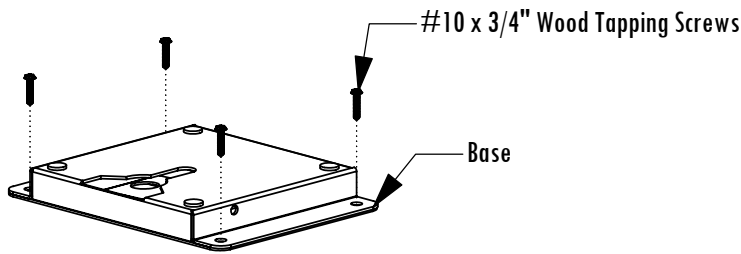

Base Installation Using Optional APSLEADS Adhesive Adaptor (Optional APSLEADS Sold Separately)

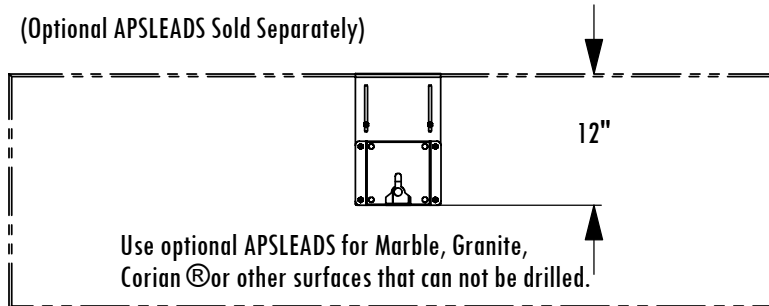

Base Installation

Using the base location determined with the instructions on page 2, drill pilot holes 3/4" deep with a 1/16" bit for each of the tapping screw locations.

attach the Base to the countertop using the provided #10 Wood Tapping Screws.

If the countertop can not be drilled, there is an optional adhesive adapter, APSLEADS, which can be used to screw into the back of the furniture and adhere to the surface of the furniture.

Follow the installation instructions for the APSLEADS to mount the Base in the appropriate location.

Top Assembly

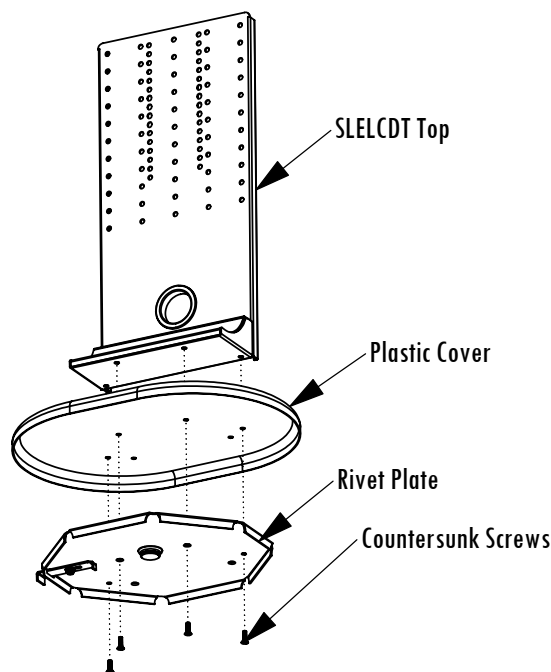

Assemble the SLELCDT Top with the Plastic Cover and Rivet Plate. Care should be taken not to scratch the Plastic Cover when it is placed between the two metal parts.

Align the three pieces and screw together with four of the six provided #10-24 Countersunk Screws.

Leave the two holes at the back of the Rivet Plate empty until after the monitor is attached.

Routing Monitor Cords

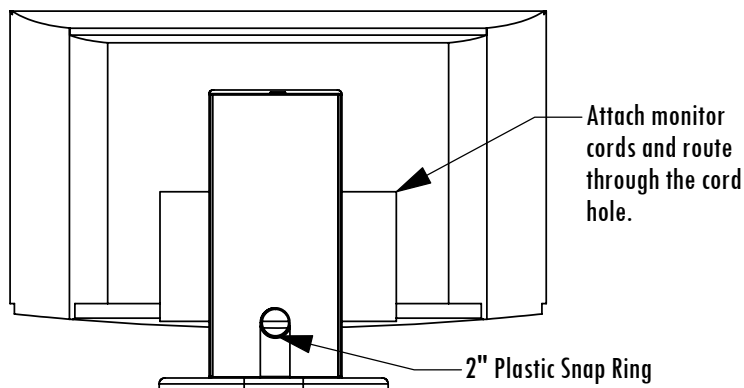

The monitor cords can be routed through the 2" center hole with a plastic snap ring or can be routed to the monitor without going through this hole depending upon the type of monitor and individual preference.

Before attaching the monitor to the SLELCDT Top Assembly, connect the monitor cords as instructed in the monitor's user manual.

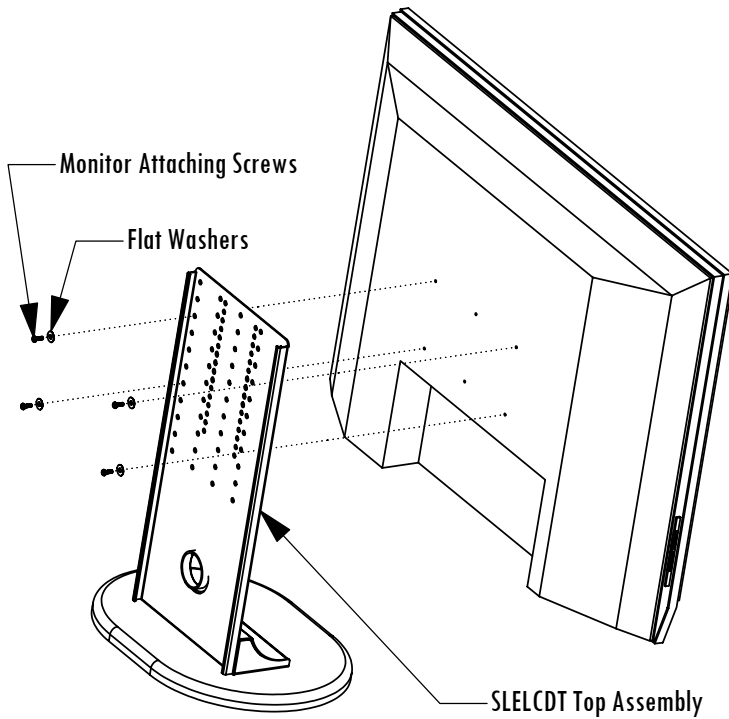

Four different detailed examples of monitor attachment to the SLELCDT Top Assembly are shown. Use the method that is closest to the type of monitor that is being installed.

WARNING! Failure to use the appropriate size and length of monitor attaching screws can cause damage to the monitor or improperly secure the monitor to the mount. The appropriate size and length of Monitor Attaching Screws are specified by the monitor manufacturer.

CAUTION! Do not block vents or connections on the back of the monitor when attaching the SLELCDT Top Assembly. Spacers and Stabilizers are included for installations that require a gap between the back of the monitor and the mount.

1 200mm without Spacers

Position the SLELCDT Top Assembly flat against the back of the monitor.

Use the mounting holes that will provide the desired elevation for the monitor.

Attach the SLELCDT Top Assembly with screws and washers to the monitor.

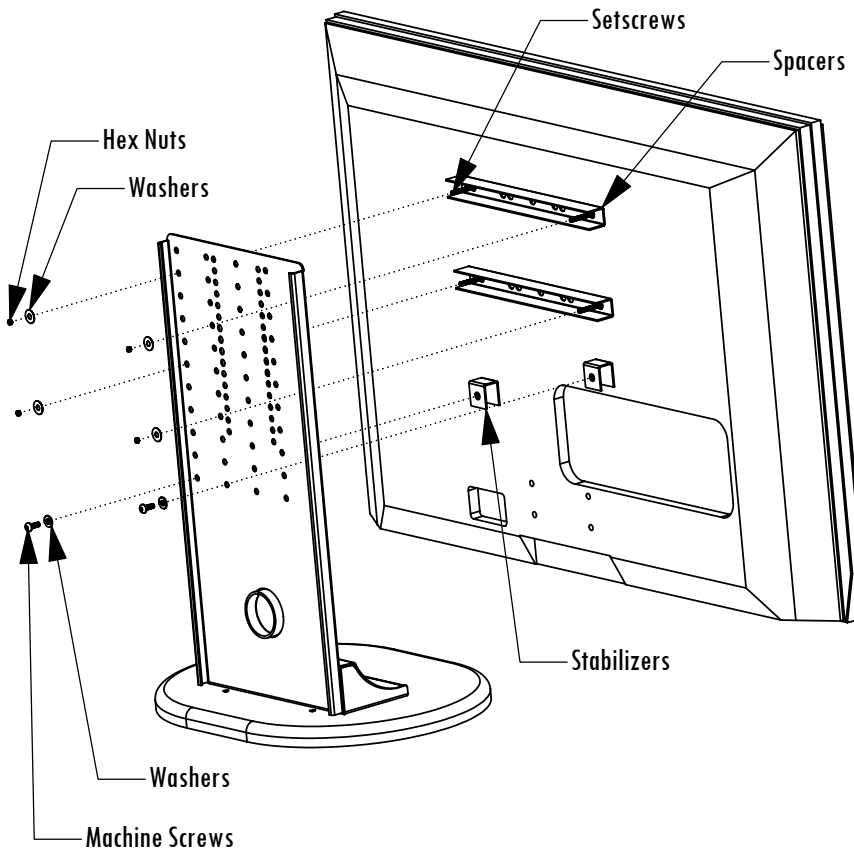

2 200mm with Spacers

Screw the Setscrews into threaded inserts on the monitor. Make sure that only 1" of the Setscrews protrude from the back of the monitor.

Place the spacers over the Setscrews with the flat side against the back of the monitor.

Place the SLELCDT Top Assembly over the Setscrews. Use mounting holes that will provide the desired elevation for the monitor.

Determine the position of the stabilizers as low and as far apart on the back of the monitor as possible. Attach the stabilizers with screws and washers to the SLELCDT Top Assembly.

Peel the adhesive off of the stabilizers.

Carefully line up the top edge of the SLELCDT mounting plate parallel to the monitor. Attach the SLELCDT mounting plate with nuts and washers.

Protected under one or more of these U.S. Patent numbers: 3,291,432; 3,159,942; 3,724,798; DES:270,689; 4,613,109; 4,878,645; 4,852,842; DES:309,5624; 973,023; 5,169,114; 5,255,884; 5,310,159; 5,522,576; 5,621,614; 5,826,384; 5,941,492; 5,944,068; 6,060,661; 6,102,398; 6,138,704; 6,454,116; 6,761,276; 6,816,425; 6,816,425; 6,816,425

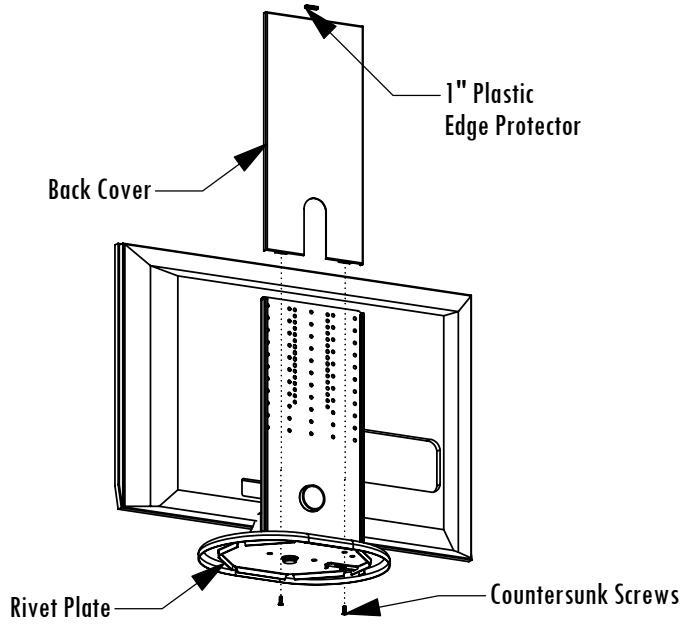

Back Cover Attachment

Check to make sure the monitor is securely attached to the Top Assembly.

Slide the 1" Plastic Edge Protector onto the center of the top edge of the Back Cover to silence any noises once the mount is assembled.

Screw the Back Cover to the Rivet Plate using the remaining two Countersunk Screws.

Monitor to Base Attachment

With the monitor attached to the Top Assembly, align the rivet on the Rivet Plate with the Triangular Slot on the Base. Slide the Top Assembly back until there is an audible click and the Top Assembly is locked into the Base. Pull forward on the monitor to ensure that the rivet has engaged the Base and the monitor is secure.

Warning! Check to ensure the monitor is locked in place and can not be disengaged from the Base. Leaving the Monitor & Top Assembly loose can result in equipment damage or injury.

Monitor Release

See the SLELCDT Base Release Instructions for details on how to release the monitor from the base once installed. The release instructions are shipped with the release rods in a separate box from the mounts for security purposes.

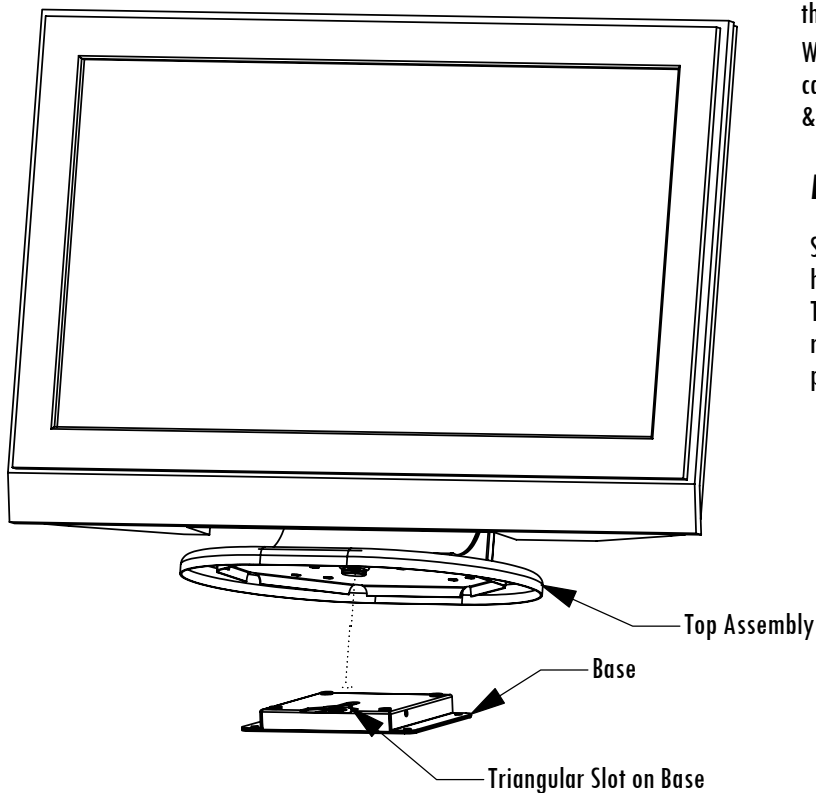

LIMITED WARRANTY

LUCASEY MANUFACTURING CORPORATION MAKES NO WARRANTY OF ANY KIND, EXPRESS OR IMPLIED except that the goods sold under this agreement shall be free of defects in materials and workmanship for a period of one year from the user's date of purchase. User assumes all risk and liability resulting from the use of the goods, whether used singly or in combination with other goods. Lucasey Manufacturing Corporation neither assumes nor authorizes any person to assume for it any other liability in connection with the sale or use of the goods sold and there are no oral agreements or warranties collateral to or affecting this limited warranty. Lucasey Manufacturing Corporation will repair or replace defective parts or equipment within one year of the date of purchase, at its option, provided the part or equipment is returned pre-paid to Lucasey Manufacturing Corporation's plant. The repaired or replaced part shall be shipped to the user, FOB Lucasey Manufacturing Corporation's plant. NO allowance for outside labor charges are implied within the terms of this limited warranty. Under no circumstances will Lucasey Manufacturing Corporation be responsible for special, indirect or consequential damages. The remedies set forth in this Limited Warranty are exclusive and the liability of Lucasey Manufacturing Corporation with respect to any contract of sale or anything done in connection therewith, whether in contract, in tort, under any warranty or otherwise shall not, except as expressly provided herein, exceed the price of the equipment or part on which such liability is based. Any damage caused by the improper use, operation beyond capacity, substitution of parts or equipment not approved by Lucasey Manufacturing Corporation, improper packaging, failure to observe installation or other instructions, transit, or repair by one other than Lucasey Manufacturing Corporation, will not be covered by and shall void this Limited Warranty.