

1 Bolt Down Base

Attach the Base to the furniture with the provided Tapping Screws.

Note: An adhesive adapter is sold separately for installations where the countertop can not be used to screw the base down.

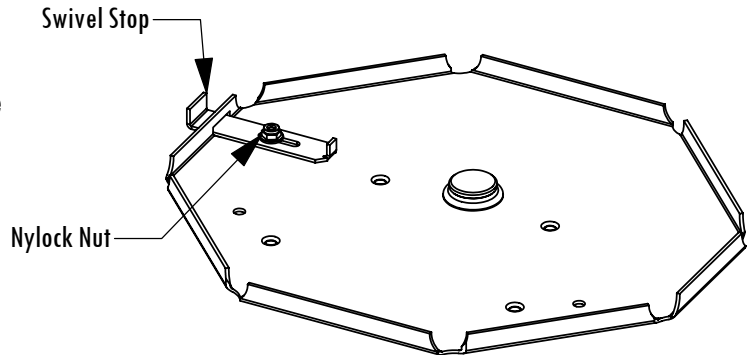

2 Adjust Swivel Stop

Adjust the Swivel Stop for the desired degree of swivel and tighten the Nylock Nut.

Note: Determine the degree of swivel by attaching the Rivet Plate to the Base, swiveling the Rivet Plate and pushing the Swivel Stop until it hits the Base.

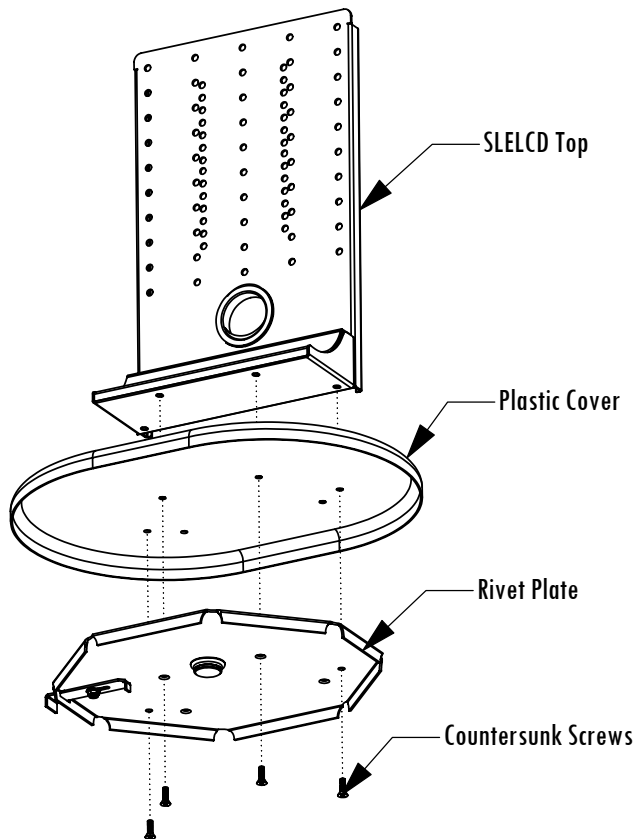

3 Assemble Top

Assemble the SLELCD Top with the Plastic Cover and Rivet Plate using 4 of the 6 Countersunk Screws provided. Leave the two back holes empty.

Component List

1 ... Base	2... Spacers	4 ... 4mm x 40mm Setscrews	4 ... 6mm x 40mm Setscrews
1 ... SLELCD Top	2... Stabilizers with Screws & Washers	4 ... 4mm x 12mm Phillips Screws	4 ... 6mm x 12mm Phillips Screws
1 ... Rivet Plate	1 ... Swivel Stop with Nylock Nut & Washer	8 ... 4mm Hex Nuts	8 ... 6mm Hex Nuts
1 ... Plastic Cover	1 ... Plastic Edge Protector	4 ... 5mm x 40mm Setscrews	12 ... 5mm Washers
1 ... Back Cover	6 ... Countersunk Screws	4 ... 5mm x 12mm Phillips Screws	12 ... 1/4" Washers
	4 ... Tapping Screws	8 ... 5mm Hex Nuts	

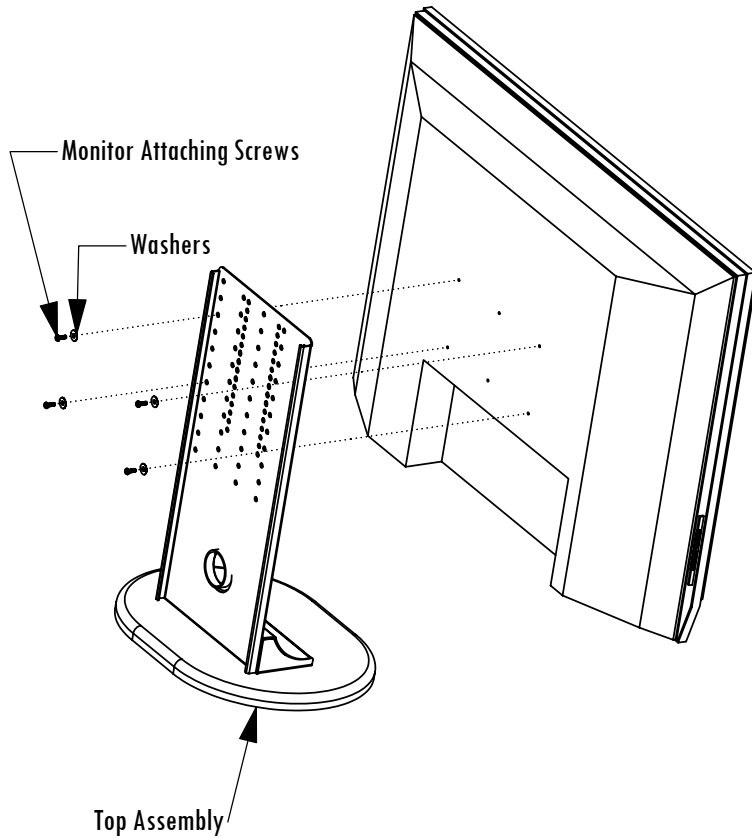

4 Monitor Attachment

Route the power and video connections to the monitor through the Plastic Snap Ring in the Top Assembly before attaching the monitor.

Attach the monitor to the Top Assembly from Step 3 using monitor attaching hardware appropriate for the type of monitor being installed.

Warning! Failure to use the appropriate size and length of monitor attaching screws may cause damage to the monitor or improperly secure the monitor to the mount. Check with the monitor manufacturer for the appropriate screws to use for monitor attachment.

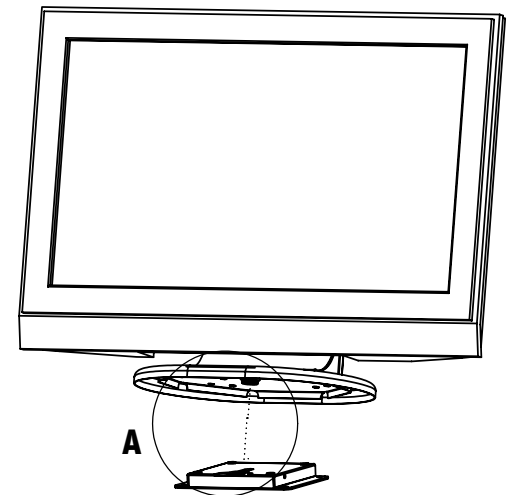

5 Back Cover

Slide the Plastic Edge Protector onto the top edge of the Back Cover to silence noises from vibrations.

Attach the Back Cover to the Top Assembly using the remaining two Countersunk Screws.

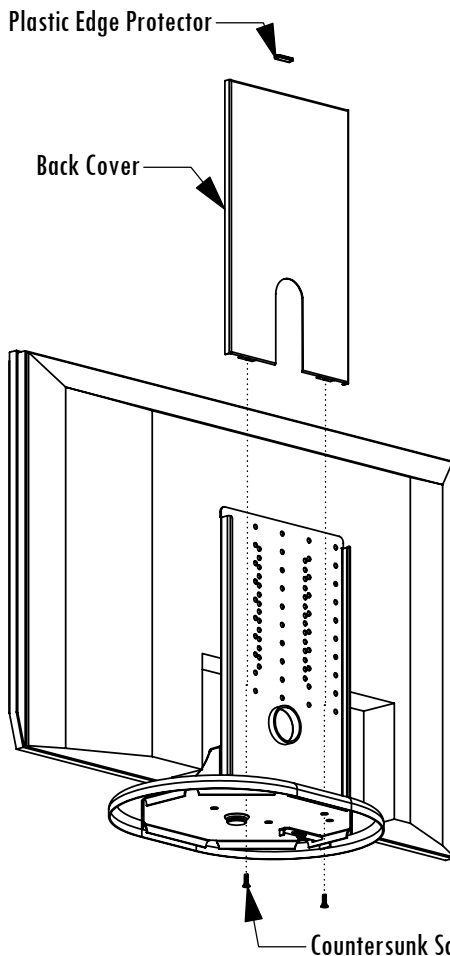

6 Click Together

Attach the assembly from Step 5 to the Base by aligning the Rivet in the bottom of the assembly with the triangular slot on the Base. Shown in Detail A. Push back until there is an audible click and the Top Assembly is locked in place.

Push the monitor backwards and forwards to make sure that it is locked in place.

Warning! Leaving the monitor and Top Assembly disconnected from the base can cause accidental injury or damage to the monitor.

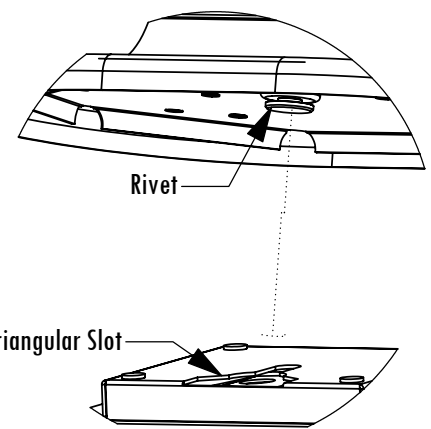

Detail A