

# SDWP Series Locking Wall Mounts

## Wall Arm Installation:

1. Use backplate of wall arm (#8) as template to mark location of top hole in wall plate. Hammer-drill 1/4" diameter hole at least 3-1/4" deep at hole location.
2. Blow dust from hole with Blow Out Bulb.
3. Insert the anchor bolt (#7) into the hole. Place washer and nut on anchor bolt. Hammer anchor bolt into hole until at least six threads on anchor bolt are below the surface of the wall plate.
4. Remove nut and washer from anchor bolt. Position wall plate on anchor bolt, and replace washer and nut. Loosely tighten nut. Level wall plate. Mark other hole locations. Hammer-drill and blow out remaining anchor bolts., Securely tighten nuts.

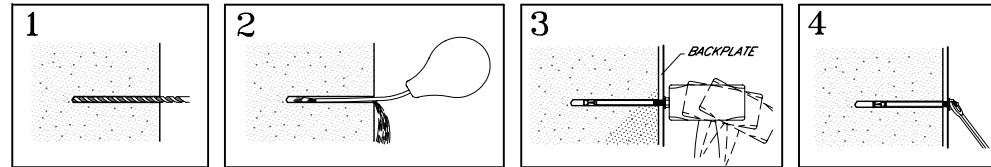

## Platform Assembly and Monitor Installation:

1. Place swivel plate (#12) and tilt plate (#10) on wall arm (#8). Insert 1/2-13 x 2-1/2" carriage bolt (#13) through wall arm, swivel plate, and tilt plate. Place 2-1/8" washer (#6) over carriage bolt. Place and tighten 12-13 nylon lock nut (#5) on carriage bolt.
2. Place lower plate (#4) on tilt plate (#10), aligning holes in lower plate with holes in tilt plate.
3. Secure lower plate to tilt plate with four 1/4-20 x 1/2" carriage bolts (#11), lock washers (#3), and 1/4-20 nuts (#2). Insert carriage bolts through bottom of tilt plate.
4. Invert monitor. Position inverted upper plate (#1) on bottom of monitor with lock slot facing front of monitor. Attach monitor to upper plate with fasteners appropriate for the underside of the monitor.
5. Turn monitor right side up. Place upper plate on lower plate, guiding rear of upper plate beneath lip at back of lower plate. Slip upper plate into lower plate and pull forward until front of upper plate meets front of lower plate.
6. Place key in lock (#9) and insert lock in lock retainer. Turn key clockwise until lock is completely screwed in, then turn back (counterclockwise) until key is vertical. Remove key.